



Bronze, Brass, Forged, S.S.
Cast Iron & Steel Valves

Catalogue



MANUFACTURER - EXPORTER OF INDUSTRIAL VALVES



For Guaranteed
Trouble-Free Service 

Cast Steel Globe Valve PN 40

PRODUCT DESCRIPTION

HSN 84818030

PRODUCT: 'INTRO' CAST STEEL GLOBE VALVE

DESIGN STANDARD: BS 5160

PRESSURE / CLASS / RATING: PN 40

BODY MATERIAL CUM STANDARD: CCS (ASTM A216 GR.WCB)

END CONNECTION: FLANGE END, RF

FLANGE DRILLING: EN 1092-1 TYPE 11 (PN-40)

FACE TO FACE: AS PER ASME B16.10

TESTING STANDARD: API 598 / BS EN 12266-1

TEST PRESSURE IN KG./CM ²	
TEST	HYDROSTATIC/ 150#
SHELL	60
SEAT	40



APPLICATION

WATER	OIL	STEAM

MATERIALS OF CONSTRUCTION

COMPONENTS	MATERIALS	SPECIFICATIONS
BODY, BONNET, GLAND FLANGE	C.S / CF8 / CF8M / CF3 / CF3M / WC6 / WC9	ASTM A216 GR.WCB
BODY SEAT RING, VALVE DISC, DISC STEM NUT, BACKSEAT BUSH, STEM, GLAND	STAINLESS STEEL	AISI-410
YOKE BUSH	MILD STEEL	AISI-410
GASKET	CAF / SPIRAL WOUND S.S 304+CAF	—
GLAND PACKING	EXPANDED PURE FLEXIBLE GRAPHITE	—
HANDWHEEL	S.G. IRON	—
FASTENERS	MILD STEEL	—

DIMENSIONS (IN MM)

NOMINAL SIZE	NOMINAL SIZE (LNCHES)	F	H (APPROX)	W
15	½	130±2		125
20	¾	150±2		125
25	1	160±2		160
32	1.1/4	180±2		160
40	1.1/2	200±2		200
50	2	230±2		200
65	2.1/2	290±2		250
80	3	310±2		250
100	4	350±2		315
125	5	400±3		315
150	6	480±3		400
200	8	600±3		400
250	10	730±4		450
300	12	850±5		600

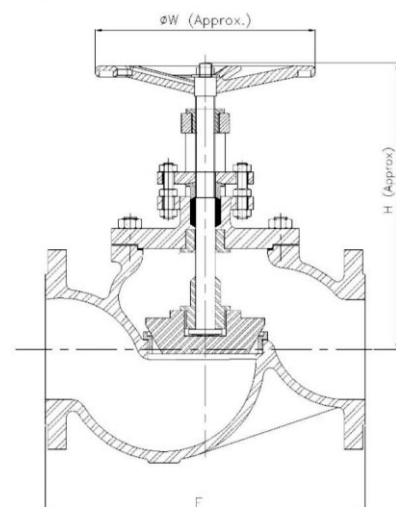

Notes

1. Product images are for illustration purposes only. Actual product may vary.
2. Actual dimensions may change over time, due to continual design improvements. Please confirm before placing order.
3. Test Certificate as per EN 10204 Type 3.1 is Provided with Each Valve, Covering Material Traceability And Hydrostatic Testing.

Cast Steel Lift Type Check Valve PN 40

PRODUCT DESCRIPTION

HSN 84818030

PRODUCT: 'INTRO' CAST STEEL LIFT TYPE CHECK VALVE

DESIGN STANDARD: BS 5160

PRESSURE / CLASS / RATING: PN 40

BODY MATERIAL CUM STANDARD: CCS (ASTM A216 GR.WCB)

END CONNECTION: FLANGE END, RF

FLANGE DRILLING: EN 1092-1 TYPE 11 (PN-40)

FACE TO FACE: AS PER ASME B16.10

TESTING STANDARD: API 598 / BS EN 12266-1



TEST PRESSURE IN KG./CM ²	
TEST	HYDROSTATIC/ 150#
SHELL	60
SEAT	40

APPLICATION

Water	Steam
-------	-------

Materials of Construction

COMPONENTS	MATERIALS	SPECIFICATIONS
BODY, COVER	C.S / CF8 / CF8M / CF3 / CF3M / WC6 / WC9	ASTM A216 GR.WCB
BODY SEAT RING, VALVE DISC	STAINLESS STEEL	AISI-410
GASKET	CAF / SPIRAL WOUND S.S 304+CAF	IS:2712 GR.C
FASTENERS	MILD STEEL	—

DIMENSIONS (IN MM)

NOMINAL SIZE	NOMINAL SIZE (LNCHES)	F	H
15	1/2	130±2	85
20	3/4	150±2	85
25	1	160±2	85
32	1.1/4	180±2	85
40	1.1/2	200±2	110
50	2	230±2	125
65	2.1/2	290±2	140
80	3	310±2	150
100	4	350±2	165
125	5	400±3	185
150	6	480±3	270
200	8	600±3	280
250	10	730±4	300
300	12	850±5	385

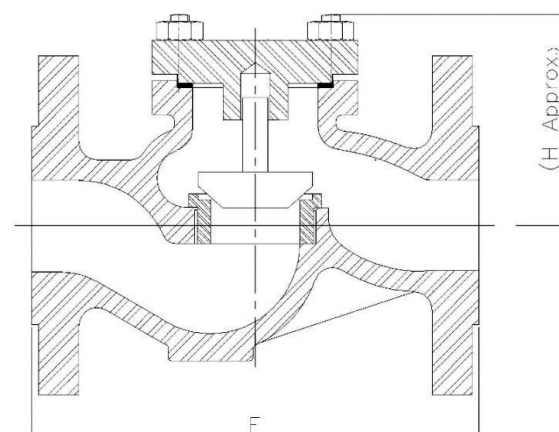

Notes

1. Product images are for illustration purposes only. Actual product may vary.
2. Actual dimensions may change over time, due to continual design improvements. Please confirm before placing order.
3. Test Certificate as per EN 10204 Type 3.1 is Provided with Each Valve, Covering Material Traceability And Hydrostatic Testing.

Cast Steel Y-Type Strainer ND 40

PRODUCT DESCRIPTION

HSN 84818030

PRODUCT: 'INTRO' CAST STEEL Y TYPE STRAINER
DESIGN STANDARD: MFG. STD.
PRESSURE / CLASS / RATING: PN 40
BODY MATERIAL CUM STANDARD: CCS (ASTM A216 GR.WCB)
END CONNECTION: FLANGE END, RF
FLANGE DRILLING: EN 1092-1 TYPE 11 (PN-40)
FACE TO FACE: AS PER ASME B16.10
TESTING STANDARD: API 598 / BS EN 12266-1



TEST PRESSURE IN KG./CM ²	
TEST	HYDROSTATIC/ 150#
SHELL	30
SEAT	N/A

APPLICATION

WATER	OIL	STEAM

MATERIALS OF CONSTRUCTION

COMPONENTS	MATERIALS	SPECIFICATIONS
BODY, COVER	C.S / CF8 / CF8M / CF3 / CF3M / WC6 / WC9	ASTM A216 GR.WCB
DRAIN PLUG	STAINLESS STEEL	AISI-410
STRAINER	STAINLESS STEEL	AISI-304,316
GASKET	CAF / SPIRAL WOUND SS 304+CAF	IS:2712 GR.C
FASTENERS	MILD STEEL	—
MESH	STAINLESS STEEL	AISI-304,316

DIMENSIONS (IN MM)

NOMINAL SIZE	NOMINAL SIZE (LNCHES)	F	H (APPROX.)
25	1	181±1	125
40	1 ½	260±2	160
50	2	277±2	205
65	2 ½	277±2	243
80	3	296±2	275
100	4	403±3	315
125	5	429±3	400
150	6	476±3	425
200	8	670±4	540

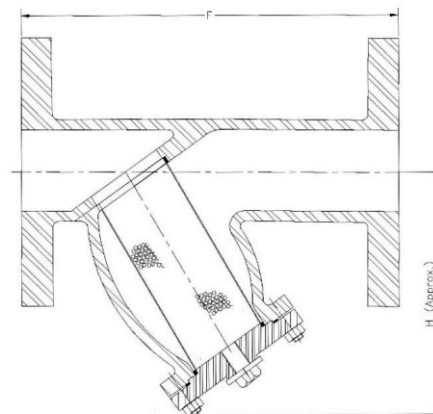

Notes

- Product images are for illustration purposes only. Actual product may vary.
- Actual dimensions may change over time, due to continual design improvements. Please confirm before placing order.
- Test Certificate as per EN 10204 Type 3.1 is Provided with Each Valve, Covering Material Traceability And Hydrostatic Testing.

Y Type Strainer Flanged, Class-150

PRODUCT DESCRIPTION

HSN 84818030

PRODUCT: 'INTRO' CAST STEEL Y TYPE STRAINER

DESIGN STANDARD: MFG. STD

PRESSURE / CLASS / RATING: AS PER 150#

BODY MATERIAL CUM STANDARD: CCS (ASTM A216 GR.WCB)

END CONNECTION: FLANGE END, RF

FLANGE DRILLING: AS PER ASME B16.5

FACE TO FACE: AS PER ASME B16.10

TESTING STANDARD: API 598 / BS EN 12266-1



TEST PRESSURE IN KG./CM ²	
TEST	HYDROSTATIC/ 150#
SHELL	30
SEAT	N/A

APPLICATION

WATER	OIL	STEAM
-------	-----	-------

MATERIALS OF CONSTRUCTION

COMPONENTS	MATERIALS	SPECIFICATIONS
BODY, COVER	C.S / CF8 / CF8M / CF3 / CF3M / WC6 / WC9	ASTM A216 GR. WCB
DRAIN PLUG	S.S.	AISI-410
MESH	S.S.	AISI-304
GASKET	CAF / SPIRAL WOUND S.S 304+CAF	—
FASTENERS	MILD STEEL	—

DIMENSIONS (IN MM)

NOMINAL SIZE	NOMINAL SIZE (LNCHES)	F	H (APPROX.)
40	1.1/2	165±2	145
50	2	185±2	155
65	2.1/2	206±2	185
80	3	255±2	210
100	4	295±2	255
150	6	385±2	300
200	8	475±3	375

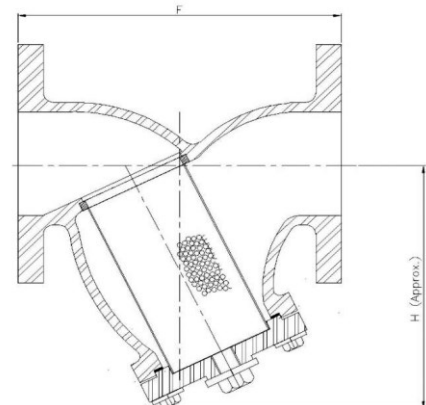

Notes

1. Product images are for illustration purposes only. Actual product may vary.
2. Actual dimensions may change over time, due to continual design improvements. Please confirm before placing order.
3. Test Certificate as per EN 10204 Type 3.1 is Provided with Each Valve, Covering Material Traceability And Hydrostatic Testing.

Cast Steel Gate Valve Flanged Class - I50

PRODUCT DESCRIPTION

HSN 84818030

PRODUCT: 'INTRO' CAST STEEL GATE VALVE
DESIGN STANDARD: API 600
PRESSURE / CLASS / RATING: AS PER I50#
BODY MATERIAL CUM STANDARD: CCS (ASTM A216 GR.WCB)
END CONNECTION: FLANGE END, RF
FLANGE DRILLING: AS PER ASME B16.5
FACE TO FACE: AS PER ASME B16.10
TESTING STANDARD: API 598



TEST PRESSURE IN KG./CM ²	
TEST	HYDROSTATIC/ 150#
SHELL	30
SEAT	21

APPLICATION

WATER	OIL	STEAM
-------	-----	-------

MATERIALS OF CONSTRUCTION

COMPONENTS	MATERIALS	SPECIFICATIONS
BODY, BONNET, YOKE, GLAND FLANGE	C.S / CF8 / CF8M / CF3 / CF3M / WC6 / WC9	ASTM A216 GR.WCB
WEDGE (UPTO 8")	STAINLESS STEEL	AISI-410 / CA15
WEDGE (FOR 10" & 12")	CAST CARBON STEEL WITH SS WELD DEPOSIT	ASTM A216 GR.WCB / AISI-410
GASKET	CAF / SPIRAL WOUND S.S 304+CAF	BS:1832
GLAND PACKING	EXPANDED PURE FLEXIBLE GRAPHITE	—
HANDWHEEL	S.G. IRON	—
BODY RINGS, GLAND YOKE FOLLOWER, SLEEVE NUT, STEM, BACKSEAT BUSH, LOCKING SCREWS	STAINLESS STEEL	AISI-410
GLAND BOLTING	CARBON STEEL	—
BOLTS	ALLOY STEEL	ASTM A193 GR.B7
NUTS	HT STEEL	ASTM A194 GR.2H
YOKE SLEEVE	MILD STEEL	—

Dimensions (in mm)

NOMINAL SIZE	NOMINAL SIZE (LNCHES)	F±2	H (APPROX)
25	1	127	260
40	1.1/2	165	290
50	2	178	315
65	2.1/2	191	355
80	3	203	400
100	4	229	475
125	5	254	560
150	6	267	635
200	8	292	810
250	10	330	1205
300	12	356	1410

NOMINAL SIZE	NOMINAL SIZE (LNCHES)	F±2	H (APPROX)
350	14	381	1539
400	16	406	1752
450	18	432	1956
500	20	457	2159
600	24	508	2565

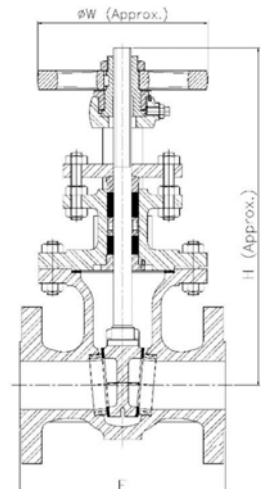

Notes

- Product images are for illustration purposes only. Actual product may vary.
- Actual dimensions may change over time, due to continual design improvements. Please confirm before placing order.
- Test Certificate as per EN 10204 Type 3.1 is Provided with Each Valve, Covering Material Traceability And Hydrostatic Testing.

Cast Steel Gate Valve Flanged, Class-300

PRODUCT DESCRIPTION

HSN 84818030

PRODUCT: 'INTRO' CAST STEEL GATE VALVE
DESIGN STANDARD: API 600
PRESSURE / CLASS / RATING: AS PER 300#
BODY MATERIAL CUM STANDARD: CCS (ASTM A216 GR.WCB)
END CONNECTION: FLANGE END, RF
FLANGE DRILLING: AS PER ASME B16.5
FACE TO FACE: AS PER ASME B16.10
TESTING STANDARD: API 598

TEST PRESSURE IN KG./CM ²	
TEST	HYDROSTATIC/ 300#
SHELL	78
SEAT	57



Application

WATER	OIL	STEAM
-------	-----	-------

MATERIALS OF CONSTRUCTION

COMPONENTS	MATERIALS	SPECIFICATIONS
BODY, BONNET, YOKE, GLAND FLANGE	C.S / CF8 / CF8M / CF3 / CF3M / WC6 / WC9	ASTM A216 GR.WCB
WEDGE (FOR 2" OR LESS)	STAINLESS STEEL	AISI-410 / CA15
WEDGE (ABOVE 2")	CAST CARBON STEEL WITH SS WELD DEPOSIT	ASTM A216 GR.WCB / AISI-410
GASKET	CAF / SPIRAL WOUND S.S 304+CAF	AISI-304
GLAND PACKING	EXPANDED PURE FLEXIBLE GRAPHITE	—
HANDWHEEL	S.G. IRON	—
BODY RINGS, GLAND YOKE FOLLOWER, SLEEVE NUT, STEM, BACKSEAT BUSH, LOCKING SCREWS	STAINLESS STEEL	AISI-410
GLAND BOLTING	CARBON STEEL	—
BOLTS	ALLOY STEEL	ASTM A193 GR.B7
NUTS	HT STEEL	ASTM A194 GR.2H
YOKE SLEEVE	-----	—

Dimensions (in mm)

NOMINAL SIZE	NOMINAL SIZE (LNCHES)	F±2	H (APPROX.)	DW (APPROX.)
40	1.1/2	191	340	178
50	2	216	355	178
65	2.1/2	241	390	210
80	3	283	435	254
100	4	305	520	254
125	5	381	605	305
150	6	403	710	400
200	8	419	855	450
250	10	457	1020	450
300	12	502	1360	530
350	14	762	1490	530
400	16	838	1691	610
450	18	914	2026	690

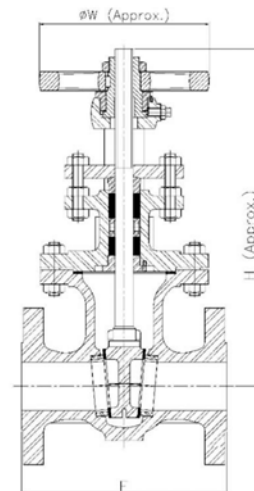

Notes

- Product images are for illustration purposes only. Actual product may vary.
- Actual dimensions may change over time, due to continual design improvements. Please confirm before placing order.
- Test Certificate as per EN 10204 Type 3.1 is Provided with Each Valve, Covering Material Traceability And Hydrostatic Testing.

CAST STEEL GATE VALVE FLANGED, CLASS-600

HSN 84818030

PRODUCT DESCRIPTION

PRODUCT: 'INTRO' CAST STEEL GATE VALVE
DESIGN STANDARD: API 600
PRESSURE / CLASS / RATING: AS PER 600#
BODY MATERIAL CUM STANDARD: CCS (ASTM A216 GR.WCB)
END CONNECTION: FLANGE END, RF , RTJ
FLANGE DRILLING: AS PER ASME B16.5
FACE TO FACE: AS PER ASME B16.10
TESTING STANDARD: API 598

TEST PRESSURE IN KG./CM ²	
TEST	HYDROSTATIC/ 600#
SHELL	156
SEAT	115

Application

WATER	OIL	STEAM
-------	-----	-------



MATERIALS OF CONSTRUCTION

COMPONENTS	MATERIALS	SPECIFICATIONS
BODY, BONNET, YOKE, GLAND FLANGE	C.S / CF8 / CF8M / CF3 / CF3M / WC6 / WC9	ASTM A216 GR.WCB
WEDGE	CAST CARBON STEEL WITH SS WELD DEPOSIT	ASTM A216 GR.WCB / AISI-410
GASKET	CAF / SPIRAL WOUND S.S 304+CAF	AISI-304
GLAND PACKING	EXPANDED PURE FLEXIBLE GRAPHITE	—
HANDWHEEL	S.G. IRON	—
BODY RINGS, GLAND YOKE FOLLOWER, SLEEVE NUT, STEM, BACKSEAT BUSH, LOCKING SCREWS	STAINLESS STEEL	AISI-410
GLAND BOLTING	CARBON STEEL	—
BOLTS	ALLOY STEEL	ASTM A193 GR.B7
NUTS	HT STEEL	ASTM A194 GR.2H
YOKE SLEEVE	-----	—

DIMENSIONS (IN MM)

NOMINAL SIZE	NOMINAL SIZE (LNCHES)	F±2	H (APPROX.)	DW (APPROX.)
40	1.1/2	241	350	229
50	2	292	400	229
65	2.1/2	330	425	229
80	3	356	465	254
100	4	432	560	305
125	5	508	665	405
150	6	559	760	450
200	8	660	925	500
250	10	787	1180	610
300	12	838	1430	640

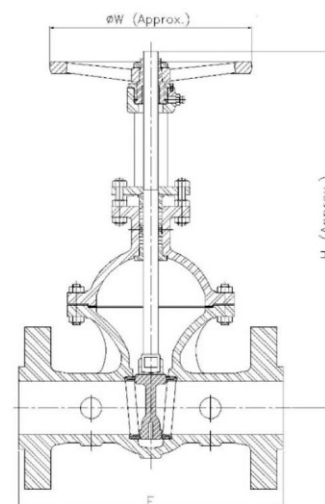

Notes

- Product images are for illustration purposes only. Actual product may vary.
- Actual dimensions may change over time, due to continual design improvements. Please confirm before placing order.
- Test Certificate as per EN 10204 Type 3.1 is Provided with Each Valve, Covering Material Traceability And Hydrostatic Testing.

CAST STEEL SWING CHECK VALVE FLANGED, CLASS-150

HSN 84813000

PRODUCT DESCRIPTION

PRODUCT: 'INTRO' CAST STEEL SWING CHECK VALVE
DESIGN STANDARD: BS 1868/ API 6D
PRESSURE / CLASS / RATING: AS PER 150#
BODY MATERIAL CUM STANDARD: CCS (ASTM A216 GR.WCB)
END CONNECTION: FLANGE END, RF
FLANGE DRILLING: AS PER ASME B16.5
FACE TO FACE: AS PER ASME B16.10
TESTING STANDARD: API 598 / BS 6755-1



TEST PRESSURE IN KG./CM ²	
TEST	HYDROSTATIC/ 150#
SHELL	30
SEAT	21

Application

WATER	OIL	STEAM
-------	-----	-------

MATERIALS OF CONSTRUCTION

COMPONENTS	MATERIALS	SPECIFICATIONS
BODY, COVER, VALVE DISC	C.S / CF8 / CF8M / CF3 / CF3M / WC6 / WC9	ASTM A216 GR.WCB
GASKET	CAF / SPIRAL WOUND SS 304+CAF	BS:1832
BODY RINGS, DISC SEAT, PIN & SIDE PLUGS	STAINLESS STEEL	AISI-410
BOLTS	ALLOY STEEL	ASTM A193 GR.B7
NUTS	HT STEEL	ASTM A194 GR.2H
LEVER	M.I. / S.G. IRON	—

DIMENSIONS (IN MM)

NOMINAL SIZE	NOMINAL SIZE (LNCHES)	F	H (APPROX)
25	1	127±2	115
40	1.1/2	165±2	130
50	2	203±2	145
65	2.1/2	216±2	155
80	3	241±2	175
100	4	292±2	200
125	5	330±2	210
150	6	356±2	240
200	8	495±3	275
250	10	622±3	368
300	12	698±3	406
350	14	787±3	432
400	16	864±3	483
450	18	978±3	600
500	20	978±3	660
550	22	1067±3	700
600	24	1295±3	740

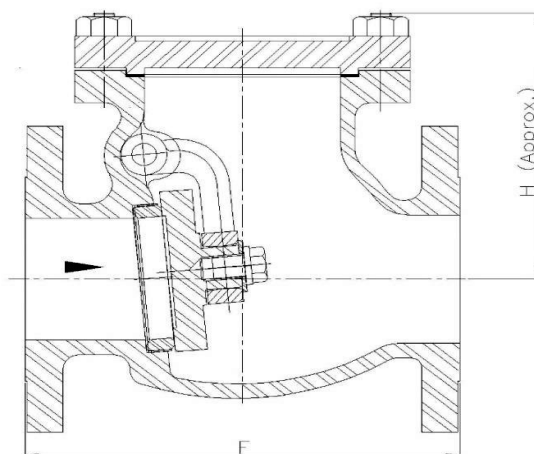

Notes

- Product images are for illustration purposes only. Actual product may vary.
- Actual dimensions may change over time, due to continual design improvements. Please confirm before placing order.
- Test Certificate as per EN 10204 Type 3.1 is Provided with Each Valve, Covering Material Traceability And Hydrostatic Testing.

CAST STEEL SWING CHECK VALVE FLANGED, CLASS-300

HSN 84813000

PRODUCT DESCRIPTION

PRODUCT: 'INTRO' CAST STEEL SWING CHECK VALVE
DESIGN STANDARD: BS 1868/ API 6D
PRESSURE / CLASS / RATING: AS PER 300#
BODY MATERIAL CUM STANDARD: CCS (ASTM A216 GR.WCB)
END CONNECTION: FLANGE END, RF
FLANGE DRILLING: AS PER ASME B16.5
FACE TO FACE: AS PER ASME B16.10
TESTING STANDARD: API 598 / BS 6755-1

TEST PRESSURE IN KG./CM ²	
TEST	HYDROSTATIC/ 300#
SHELL	78
SEAT	57



APPLICATION

WATER	OIL	STEAM
-------	-----	-------

MATERIALS OF CONSTRUCTION

COMPONENTS	MATERIALS	SPECIFICATIONS
BODY, COVER, VALVE DISC	C.S / CF8 / CF8M / CF3 / CF3M / WC6 / WC9	ASTM A216 GR.WCB
GASKET	CAF / SPIRAL WOUND S.S 304+CAF	BS:1832
BODY RINGS, DISC SEAT, PIN & SIDE PLUGS	STAINLESS STEEL	AISI-410
BOLTS	ALLOY STEEL	ASTM A193 GR.B7
NUTS	HT STEEL	ASTM A194 GR.2H
LEVER	M.I. / S.G. IRON	—

DIMENSIONS (IN MM)

NOMINAL SIZE	NOMINAL SIZE (LNCHES)	F	H (APPROX)
40	1.1/2	241±2	155
50	2	267±2	178
65	2.1/2	292±2	191
80	3	318±2	211
100	4	356±2	246
125	5	400±2	305
150	6	444±2	318
200	8	533±2	356
250	10	622±3	394
300	12	711±3	482
350	14	838±3	533
400	16	864±3	584
450	18	978±3	590
500	20	1016±3	614

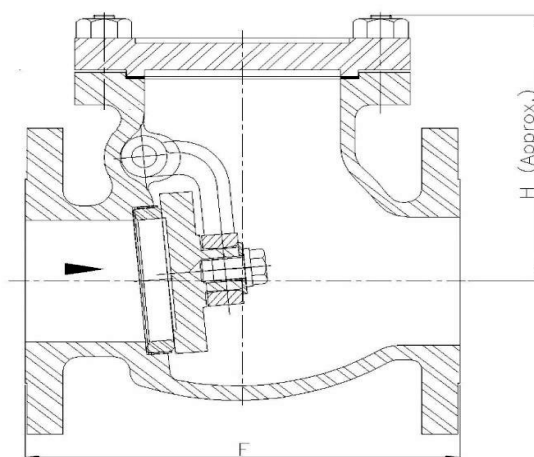

Notes

1. Product images are for illustration purposes only. Actual product may vary.
2. Actual dimensions may change over time, due to continual design improvements. Please confirm before placing order.
3. Test Certificate as per EN 10204 Type 3.1 is Provided with Each Valve, Covering Material Traceability And Hydrostatic Testing.

CAST STEEL SWING CHECK VALVE FLANGED, CLASS-600

HSN 84813000

PRODUCT DESCRIPTION

PRODUCT: 'INTRO' CAST STEEL SWING CHECK VALVE
DESIGN STANDARD: BS 1868/ API 6D
PRESSURE / CLASS / RATING: AS PER 600#
BODY MATERIAL CUM STANDARD: CCS (ASTM A216 GR.WCB)
END CONNECTION: FLANGE END, RF , RTJ
FLANGE DRILLING: AS PER ASME B16.5
FACE TO FACE: AS PER ASME B16.10
TESTING STANDARD: API 598 / BS 6755-1

TEST PRESSURE IN KG./CM ²	
TEST	HYDROSTATIC/ 300#
SHELL	156
SEAT	115



APPLICATION

WATER	OIL	STEAM
-------	-----	-------

Materials of Construction

COMPONENTS	MATERIALS	SPECIFICATIONS
BODY, COVER, VALVE DISC	C.S / CF8 / CF8M / CF3 / CF3M / WC6 / WC9	ASTM A216 GR.WCB
GASKET	CAF / SPIRAL WOUND S.S 304+CAF	BS:1832
BODY RINGS, DISC SEAT, PIN & SIDE PLUGS	STAINLESS STEEL	AISI-410
BOLTS	ALLOY STEEL	ASTM A193 GR.B7
NUTS	HT STEEL	ASTM A194 GR.2H
LEVER	M.I. / S.G. IRON	—

Dimensions (in mm)

NOMINAL SIZE	NOMINAL SIZE (LNCHES)	F	H (APPROX)
40	1.1/2	241±2	180
50	2	292±2	187
65	2.1/2	330±2	216
80	3	356±2	278
100	4	432±2	305
125	5	500±2	N/A
150	6	559±2	390
200	8	660±2	420
250	10	787±3	465
300	12	838±3	500
350	14	889±3	565
400	16	991±3	650

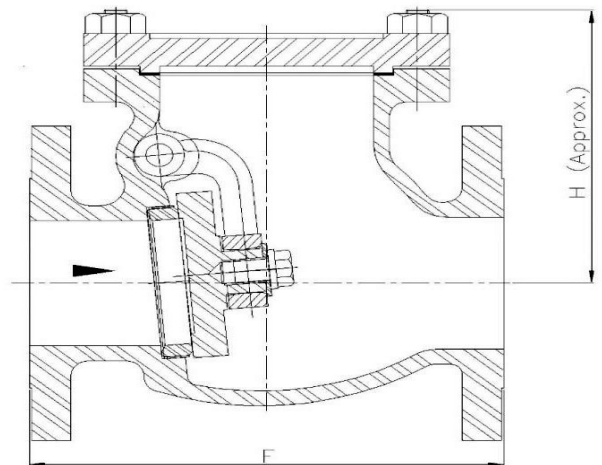

Notes

- Product images are for illustration purposes only. Actual product may vary.
- Actual dimensions may change over time, due to continual design improvements. Please confirm before placing order.
- Test Certificate as per EN 10204 Type 3.1 is Provided with Each Valve, Covering Material Traceability And Hydrostatic Testing.

Cast Steel Globe Valve Flanged, Class-150

PRODUCT DESCRIPTION

HSN 84818030

PRODUCT: 'INTRO' CAST STEEL GLOBE VALVE
DESIGN STANDARD: BS 1873
PRESSURE / CLASS / RATING: AS PER 150#
BODY MATERIAL CUM STANDARD: CCS (ASTM A216 GR.WCB)
END CONNECTION: FLANGE END, RF,
FLANGE DRILLING: AS PER ASME B16.5
FACE TO FACE: AS PER ASME B16.10
TESTING STANDARD: API 598 / BS 6755-1



TEST PRESSURE IN KG./CM ²	
TEST	HYDROSTATIC/ 150#
SHELL	30
SEAT	21

APPLICATION

WATER	OIL	STEAM

MATERIALS OF CONSTRUCTION

COMPONENTS	MATERIALS	SPECIFICATIONS
BODY, BONNET, GLAND FLANGE	C.S / CF8 / CF8M / CF3 / CF3M / WC6 / WC9	ASTM A216 GR.WCB
GASKET	CAF / SPIRAL WOUND S.S 304+CAF	—
GLAND PACKING	EXPANDED PURE FLEXIBLE GRAPHITE	—
HANDWHEEL	S.G. IRON	—
BODY RINGS, GLAND FOLLOWER, STEM, LOCKING SCREWS	STAINLESS STEEL	AISI-410
GLAND BOLTING	CARBON STEEL	—
BOLTS	ALLOY STEEL	ASTM A193 GR.B7
NUTS	HT STEEL	ASTM A194 GR.2H
YOKE BUSH	AL BRONZE	—

DIMENSIONS (IN MM)

NOMINAL SIZE	NOMINAL SIZE (LNCHES)	F	H (APPROX)	W
25	1	127	255	125
32	1.1/4	140	265	125
40	1.1/2	165	270	160
50	2	203	290	160
65	2.1/2	211	355	200
80	3	241	380	200
100	4	292	420	250
150	6	406	515	315
200	8	495	610	400
250	10	622	620	450
300	12	698	720	500

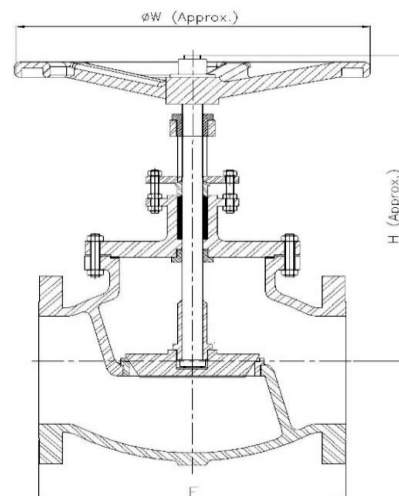

Notes

- Product images are for illustration purposes only. Actual product may vary.
- Actual dimensions may change over time, due to continual design improvements. Please confirm before placing order.
- Test Certificate as per EN 10204 Type 3.1 is Provided with Each Valve, Covering Material Traceability And Hydrostatic Testing.

Cast Steel Globe Valve Flanged, Class-300

PRODUCT DESCRIPTION

HSN 84818030

PRODUCT: 'INTRO' CAST STEEL GLOBE VALVE
DESIGN STANDARD: BS 1873
PRESSURE / CLASS / RATING: AS PER 300#
BODY MATERIAL CUM STANDARD: CCS (ASTM A216 GR.WCB)
END CONNECTION: FLANGE END, RF,
FLANGE DRILLING: AS PER ASME B16.5
FACE TO FACE: AS PER ASME B16.10
TESTING STANDARD: API 598 / BS 6755-1



TEST PRESSURE IN KG./CM ²	
TEST	HYDROSTATIC/ 300#
SHELL	78
SEAT	57

APPLICATION

WATER	OIL	STEAM

MATERIALS OF CONSTRUCTION

COMPONENTS	MATERIALS	SPECIFICATIONS
BODY, BONNET, GLAND FLANGE	C.S / CF8 / CF8M / CF3 / CF3M / WC6 / WC9	ASTM A216 GR.WCB
BODY RING, VALVE DISC, GLAND FOLLOWER, BACK SEAT BUSH, STEM, LOCKING SCREWS, LANTERN RING	STAINLESS STEEL	AISI-410
GASKET	CAF / SPIRAL WOUND S.S 304+CAF	AISI-304
GLAND PACKING	EXPANDED PURE FLEXIBLE GRAPHITE	—
HANDWHEEL	S.G. IRON	—
GLAND BOLTING	CARBON STEEL	—
BOLTS	ALLOY STEEL	ASTM A 193 GR.B7
NUTS	HT STEEL	ASTM A194 GR.2H
YOKE BUSH	AL BRONZE	—

DIMENSIONS (IN MM)

NOMINAL SIZE	NOMINAL SIZE (LNCHES)	F	H (APPROX)	W
25	1	203±2	280	160
32	1.1/4	216±2	280	160
40	1.1/2	229±2	325	200
50	2	267±2	335	200
65	2.1/2	292±2	400	250
80	3	318±2	410	250
100	4	356±2	500	315
150	6	445±2	585	400
200	8	559±2	680	400
250	10	622±3	720	560
300	12	711±3	800	610

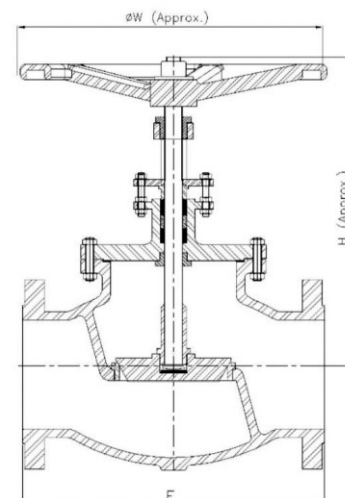

Notes

- Product images are for illustration purposes only. Actual product may vary.
- Actual dimensions may change over time, due to continual design improvements. Please confirm before placing order.
- Test Certificate as per EN 10204 Type 3.1 is Provided with Each Valve, Covering Material Traceability And Hydrostatic Testing.

Cast Steel Globe Valve Flanged, Class-600

HSN 84818030

PRODUCT DESCRIPTION

PRODUCT: 'INTRO' CAST STEEL GLOBE VALVE
DESIGN STANDARD: BS 1873
PRESSURE / CLASS / RATING: AS PER 600#
BODY MATERIAL CUM STANDARD: CCS (ASTM A216 GR.WCB)
END CONNECTION: FLANGE END, RF, RTJ
FLANGE DRILLING: AS PER ASME B16.5
FACE TO FACE: AS PER ASME B16.10
TESTING STANDARD: API 598 / BS 6755-1



TEST PRESSURE IN KG./CM ²	
TEST	HYDROSTATIC/ 600#
SHELL	78
SEAT	57

APPLICATION

WATER	OIL	STEAM
-------	-----	-------

MATERIALS OF CONSTRUCTION

COMPONENTS	MATERIALS	SPECIFICATIONS
BODY, BONNET, DISC, GLAND FLANGE	C.S / CF8 / CF8M / CF3 / CF3M / WC6 / WC9	ASTM A216 GR. WCB
STEM, BACK SEAT BUSH, BODY SEAT RING, VALVE DISC RING, GLAND FOLLOWER, LANTERN RING & THRUST PLATE	STAINLESS STEEL	AISI-410
GASKET	CAF / SPIRAL WOUND S.S 304+CAF	—
GLAND PACKING	EXPANDED PURE FLEXIBLE GRAPHITE	—
FASTENERS	MILD STEEL	—
YOKE BUSH	ALUMINUM BRONZE	—
HANDWHEEL	S.G. IRON	—

DIMENSIONS (IN MM)

NOMINAL SIZE	NOMINAL SIZE (LNCHES)	F ±2	H (APPROX.)	CW (APPROX.)
40	1.1/2	242	305	200
50	2	292	360	254
65	2.1/2	330	405	305
80	3	356	450	305
100	4	432	525	450
150	6	559	670	560
200	8	660	740	600

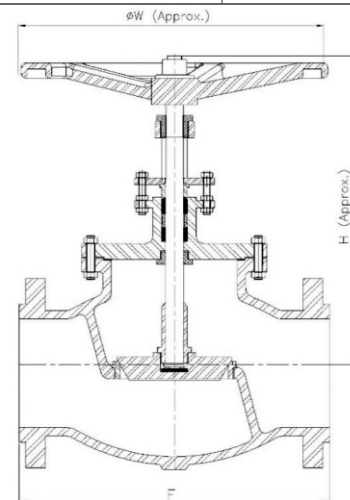

Notes

- Product images are for illustration purposes only. Actual product may vary.
- Actual dimensions may change over time, due to continual design improvements. Please confirm before placing order.
- Test Certificate as per EN 10204 Type 3.1 is Provided with Each Valve, Covering Material Traceability And Hydrostatic Testing.

Cast Steel Ball Valve Flanged End. 3 Piece Full Bore

PRODUCT DESCRIPTION

HSN 84818030

PRODUCT: 'INTRO' CAST STEEL 3 PIECE BALL VALVE
DESIGN STANDARD: BS 535 I
PRESSURE / CLASS / RATING: AS PER 150# / 300#
BODY MATERIAL CUM STANDARD: CCS (ASTM A216 GR.WCB)
END CONNECTION: FLANGE END, RF,
FLANGE DRILLING: AS PER ASME B16.5
FACE TO FACE: AS PER ASME B16.10
TESTING STANDARD: BS 6755-1



TEST PRESSURE IN KG./CM ²		
TEST	HYDROSTATIC/ 150#	300#
SHELL	30	78
SEAT	21	57

APPLICATION

WATER	OIL	GAS	STEAM
-------	-----	-----	-------

MATERIALS OF CONSTRUCTION

COMPONENTS	MATERIALS	SPECIFICATIONS
LEVER	STEEL	WITH PVC SLEEVE
STEM, NUT, GLAND	13% CR. S.S	AISI-410
STOPPER	STEEL	—
PACKING RING, SEAT	PTFE / RPTFE	—
STUDS & NUTS	ALLOY STEEL & H.T. STEEL	ASTM A193 GR.B7 & ASTM A194 GR.2H
BALL	STAINLESS STEEL	CF8 / AISI-304
BODY, BODY CONNECTOR	C.S / CF8 / CF8M / CF3 / CF3M	ASTM A216 GR.WCB
GASKET	CAF / SPIRAL WOUND S.S 304+CAF	BS:1832

DIMENSIONS (IN MM) 150#

Nominal Size	Nominal Size (Inches)	F	H (Approx)	LL (Approx)
25	1	127±2	80	165
32	1.1/4	140±2	95	205
40	1.1/2	165±2	100	220
50	2	178±2	106	220
65	2.1/2	191±2	145	350
80	3	203±2	155	400
100	4	229±2	175	450
150	6	394±2	241	N/A
200	8	457±2	286	N/A
250	10	533±3	330	N/A
300	12	610±3	412	N/A
350	14	686±3	438	N/A
400	16	762±3	470	N/A
450	18	864±3	540	N/A
500	20	914±3	578	N/A

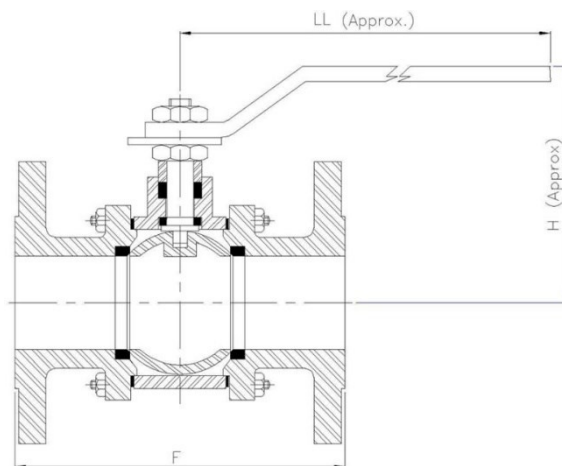

Our Extended Range Includes:

- Trunnion Mounted Ball Valve in 300#/600#/900#
- Reduced Bore Ball Valves in 300#/600#

Notes

1. Product images are for illustration purposes only. Actual product may vary.
2. Actual dimensions may change over time, due to continual design improvements. Please confirm before placing order.
3. Test Certificate as per EN 10204 Type 3.1 is Provided with Each Valve, Covering Material Traceability And Hydrostatic Testing.

Cast Steel Ball Valve 2 Piece Full Bore

PRODUCT DESCRIPTION

HSN 84818030

PRODUCT: 'INTRO' CAST STEEL 2 PIECE BALL VALVE
DESIGN STANDARD: BS 535 I
PRESSURE / CLASS / RATING: AS PER 150# / 300# / 600#
BODY MATERIAL CUM STANDARD: CCS (ASTM A216 GR.WCB)
END CONNECTION: FLANGE END, RF,
FLANGE DRILLING: AS PER ASME B16.5
FACE TO FACE: AS PER ASME B16.10
TESTING STANDARD: BS 6755-1



TEST PRESSURE IN KG./CM ²			
TEST	HYDROSTATIC/ 150# 300# 600#		
	SHELL	30	78
SEAT	21	57	115

Application

WATER	OIL	GAS	STEAM
-------	-----	-----	-------

MATERIALS OF CONSTRUCTION

COMPONENTS	MATERIALS	SPECIFICATIONS
LEVER	STEEL	WITH PVC SLEEVE
STEM, NUT, GLAND	13% CR. S.S	AISI-410
STOPPER	STEEL	—
PACKING RING, SEAT	PTFE / RPTFE	—
STUDS & NUTS	ALLOY STEEL & H.T. STEEL	ASTM A193 GR.B7 & ASTM A194 GR.2H
BALL	STAINLESS STEEL	CF8 / AISI-304
BODY, BODY CONNECTOR	C.S / CF8 / CF8M / CF3 / CF3M	ASTM A216 GR.WCB
GASKET	CAF / SPIRAL WOUND S.S 304+CAF	BS:1832

DIMENSIONS (IN MM) 300#

NOMINAL SIZE	NOMINAL SIZE (LNCHES)	F	H (APPROX)	LL (APPROX)
40	1.1/2	190	117	220
50	2	216	194	220
65	2.1/2	241	165	350
80	3	282	200	400
100	4	305	200	450
150	6	403	250	N/A
200	8	502	300	N/A
250	10	568	300	N/A
300	12	648	400	N/A
350	14	762	450	N/A
400	16	838	450	N/A

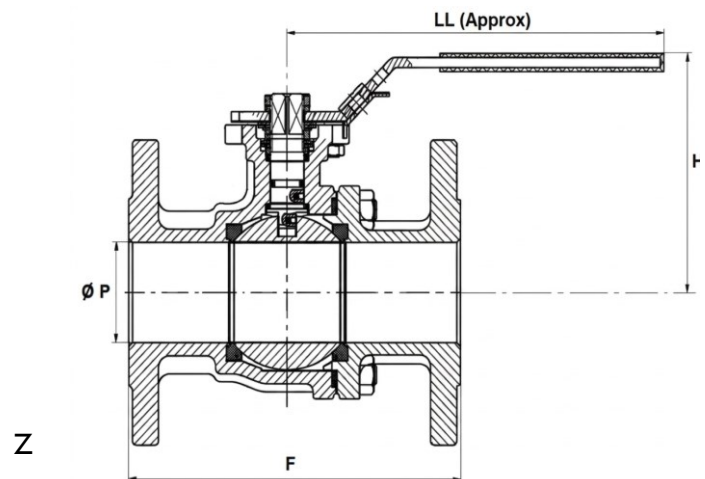

Our Extended Range Includes:

- Trunnion Mounted Ball Valve in 300#/600#/900#
- Reduced Bore Ball Valves in 300#/600#

Notes

1. Product images are for illustration purposes only. Actual product may vary.
2. Actual dimensions may change over time, due to continual design improvements. Please confirm before placing order.
3. Test Certificate as per EN 10204 Type 3.1 is Provided with Each Valve, Covering Material Traceability And Hydrostatic Testing.

Cast Steel Foot

PRODUCT DESCRIPTION

HSN 84818030

PRODUCT: 'INTRO' CAST STEEL FOOT VALVE

DESIGN STANDARD: MFG.

PRESSURE / CLASS / RATING: AS PER PN-10 / 150#

BODY MATERIAL CUM STANDARD: CCS (ASTM A216 GR.WCB)

END CONNECTION: FLANGE END, RF ,

FLANGE DRILLING: AS PER ASME B16.5

TESTING STANDARD: API 598



TEST PRESSURE IN KG./CM ²	
TEST	HYDROSTATI C
SHELL	15
SEAT	10

APPLICATION

WATER	STEAM
-------	-------

Materials of Construction

COMPONENTS	MATERIALS	SPECIFICATIONS
BODY , COVER	C.I / WCB / CF8 / CF8M	ASTM A216 GR.WCB
DICK , SEAT	GUM METAL	LG2, LG4, GI
PURPOTED NET	S.S 304 / S.S 316	CF8 / AISI-304 / CF8M / AISI-316
BOLT , NUT	C.S / M.S	ASTM A 193 GR.B7 & ASTM A 194 GR.2H
PACKING	RUBBER	-----
PILLER	S.S 410 / S.S 304 / S.S 316	CF8 / AISI-304 / CF8M / AISI-316 / AISI-410
SPRING	S.S 410 / S.S 304 / S.S 316	CF8 / AISI-304 / CF8M / AISI-316 / AISI-410
MESH COVER	C.S / M.S	ASTM A 193 GR.B7 & ASTM A 194 GR.2H

DIMENSIONS (IN MM)

NOMINAL SIZE	NOMINAL SIZE (LNCHES)	F
40	1.1/2	160
50	2	180
65	2.1/2	195
80	3	210
100	4	250
150	6	295
200	8	360
250	10	425
300	12	500
350	14	565
400	16	660
450	18	750
500	20	840
550	22	930
600	24	1020

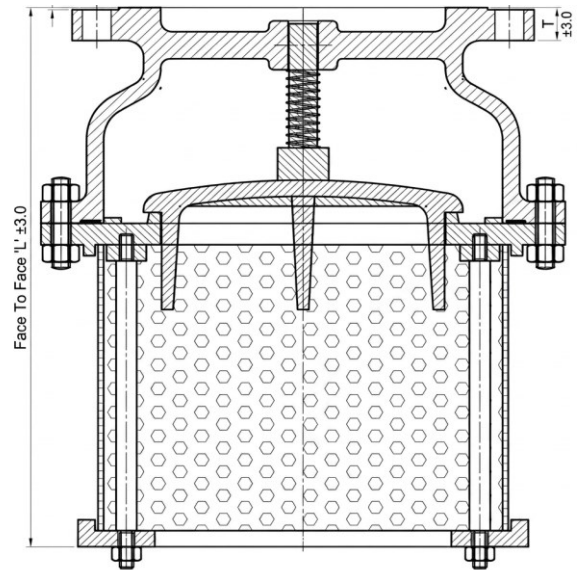

Notes

1. Product images are for illustration purposes only. Actual product may vary.
2. Actual dimensions may change over time, due to continual design improvements. Please confirm before placing order.
3. Test Certificate as per EN 10204 Type 3.1 is Provided with Each Valve, Covering Material Traceability And Hydrostatic Testing.

Cast Steel Butterfly Valves

PRODUCT DESCRIPTION

HSN 84818030

PRODUCT: 'INTRO' CAST STEEL BUTTERFLY VALVE

DESIGN STANDARD: API 609

PRESSURE / CLASS / RATING: AS PER PN-10 / 150#

'BODY MATERIAL CUM STANDARD: CCS (ASTM A216 GR.WCB)

END CONNECTION: FLANGE END,

FLANGE DRILLING: AS PER ASME B16.10

FACE TO FACE: ASME B16.10

TESTING STANDARD: API 598

TEST PRESSURE IN KG./CM ²		
TEST	HYDROSTATIC PN10	150#
	300#	
SHELL	15	30 77
SEAT	10	21 56



APPLICATION

WATER	STEAM
-------	-------

MATERIALS OF CONSTRUCTION

COMPONENTS	MATERIALS
BODY	C.I / WCB / CF8 / CF8M / CN 7M
SLEEVE	NITRILE / EPDM / VITON / PTFE / SILICON
DISC	C.I / SG IRON / WCB / CF8 / CF8M / CN7M
STEM	S.S 410 / S.S 304 / S.S 316 / CN 7M
"O" RING	NITRILE / NEOPRENE / PTFE
WETHER SEAL	NITRILE / NEOPRENE / PTFE
GEAR BOX	ANY BEST INDIAN MAKE

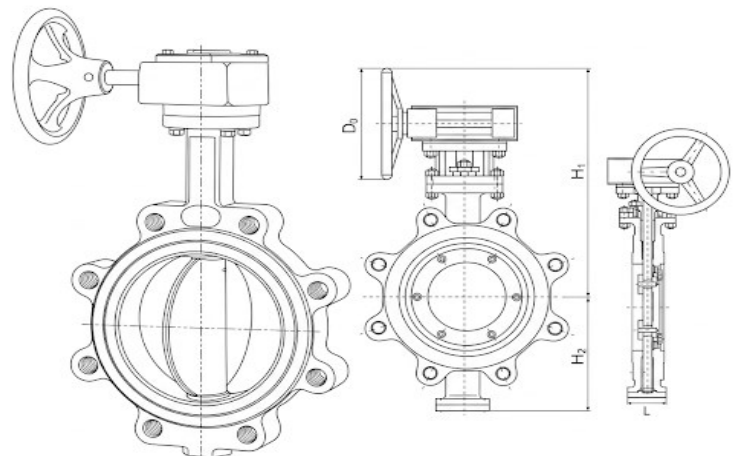

DIMENSIONS (IN MM) 150#

Size	L	H1	H2	Do
50	43	305	115	160
65	46	315	125	160
80	48	330	135	160
100	54	360	150	160
150	57	515	185	250
200	64	530	240	250
250	71	550	275	250
300	81	660	315	320
350	92	670	330	350
400	102	730	365	350
450	114	810	390	350
500	127	890	430	400
600	154	940	470	400
700	165	1030	510	400
800	190	1150	570	450
900	203	1215	640	450
1000	216	1260	670	500
1200	254	1405	800	500

DIMENSIONS (IN MM) 300#

Size	L	H1	H2	Do
50	43	315	115	160
65	46	325	125	160
80	48	340	140	160
100	54	440	160	280
150	59	515	220	280
200	73	530	260	250
250	83	630	300	350
300	92	685	335	350
350	117	780	375	350
400	133	840	405	400
450	149	925	445	400
500	159	975	475	400
600	181	1075	540	450
700	--	--	--	--
800	--	--	--	--
900	--	--	--	--
1000	--	--	--	--
1200	--	--	--	--

Notes

1. Product images are for illustration purposes only. Actual product may vary.
2. Actual dimensions may change over time, due to continual design improvements. Please confirm before placing order.
3. Test Certificate as per EN 10204 Type 3.1 is Provided with Each Valve, Covering Material Traceability And Hydrostatic Testing.

FORGE STEEL VALVE INT-FSV SERIESE

SIZE	½" to 2"
MODEL	INT-A01
PRESSURE	150# to 2500#
ENDS.	FLANGED/ SOCKET WELD/SCREW D
MOC	Forged cast Steel
TEMP.	-29° to 425°c
PRODUCT	<i>INT-A01-FSV / Forged Steel Gate Valve</i>



SIZE	½" to 2"
MODEL	INT-A05
PRESSURE	150# to 2500#
ENDS.	FLANGED/ SOCKET WELD/SCREW D
MOC	Forged cast Steel
TEMP.	-29° to 425°c
PRODUCT	<i>INT-A05-FSV / Forged Lift Check Valve</i>



SIZE	½" to 2"
MODEL	INT-A03
PRESSURE	150# to 2500#
ENDS.	FLANGED/ SOCKET WELD/SCREW D
MOC	Forged cast Steel
TEMP.	-29° to 425°c
PRODUCT	<i>INT-A03-FSV / Forged Steel Globe Valve</i>



SIZE	½" to 2"
MODEL	INT-A04
PRESSURE	150# to 2500#
ENDS.	FLANGED/ SOCKET WELD/SCREW D
MOC	Forged cast Steel
TEMP.	400° to 425°c
PRODUCT	<i>INT-A04-FSV / Forged Steel Globe Valve R.B</i>



SIZE	½" to 2"
MODEL	INT-A02
PRESSURE	150# to 2500#
ENDS.	FLANGED/ SOCKET WELD/SCREW D
MOC	Forged cast Steel
TEMP.	-29° to 425°c
PRODUCT	<i>INT-A02-FSV / Forged Steel Gate Valve R.B</i>



SIZE	½" to 2"
MODEL	INT-A06
PRESSURE	150# to 2500#
ENDS.	FLANGED/ SOCKET WELD/SCREW D
MOC	Forged cast Steel
TEMP.	-29° to 425°c
PRODUCT	<i>INT-A06-FSV / Forged Lift Check Valve R.B</i>



SIZE	½" to 2"
MODEL	INT-B01
PRESSURE	450 PSI/G/600#
ENDS.	FLANGED/ SOCKET WELD/SCREW D
MOC	Forged cast Steel
TEMP.	-29° to 425°c
PRODUCT	<i>INT-B01-TST (Thermodynamic Steam Trap)</i>



SIZE	½" to 2"
MODEL	INT-B02
PRESSURE	1500#
ENDS.	SOCKET WELD/
MOC	Forged cast Steel
TEMP.	-29 to 425°c
PRODUCT	<i>INT-B02-SW / Forged Steel Globe Valve</i>



SIZE	½" to 2"
MODEL	INT-B03
PRESSURE	600#
ENDS.	FLANGED/
MOC	Forged cast Steel
TEMP.	-29 to 425°c
PRODUCT	<i>INT-B03-FE / Forged Steel Globe Valve</i>



SIZE	½" to 2"
MODEL	INT-B04
PRESSURE	600#
ENDS.	FLANGED/
MOC	Forged cast Steel
TEMP.	-29° to 425°c
PRODUCT	<i>INT-B04-FE / Forged Steel Gate Valve</i>



SIZE	½" to 2"
MODEL	INT-B05
PRESSURE	800#
ENDS.	Screwed End NPT Threads
MOC	Forged cast Steel
TEMP.	-29 to 425°c
PRODUCT	<i>INT-B05-FP / Forged Steel Piston Valve</i>



SIZE	½" to 2"
MODEL	INT-B06
PRESSURE	150# to 2500#
ENDS.	Screwed End.
MOC	Forged cast Steel
TEMP.	-29 to 425°c
PRODUCT	<i>INT-B06-FE / Forged Steel Globe Valve</i>



SIZE	½" to 2"
MODEL	INT-C01
PRESSURE	15#
ENDS.	Screwed End/
MOC	Forged cast Steel
TEMP.	-29° to 425°c
PRODUCT	<i>INT-C01-SEYS / Y Type Strainer</i>



SIZE	½" to 2"
MODEL	INT-C02
PRESSURE	150# 300#
ENDS.	Screwed End NPT Threads
MOC	Forged cast Steel
TEMP.	-29 to 425°c
PRODUCT	<i>INT-C02-SE / Forged Steel Ball Valve</i>



SIZE	½" to 2"
MODEL	INT-C03
PRESSURE	300# (60kg.)
ENDS.	Screwed End/
MOC	Forged cast Steel
TEMP.	-20 to 180°c
PRODUCT	<i>INT-C03-S04 / Investm Casting Ball Valve</i>



Notes

1. Product images are for illustration purposes only. Actual product may vary.
2. Actual dimensions may change over time, due to continual design improvements. Please confirm before placing order.
3. Test Certificate as per EN 10204 Type 3.1 is Provided with Each Valve, Covering Material Traceability And Hydrostatic Testing.

Pneumatic Operated Valves

SIZE	1" to 12"
SEAT	PTFE/CFT/GFT/ TFM/PEEK
PRESSURE	150# to 300#
ENDS.	FLANGED END/
MOC	WCB / CF8 / CF8M / CF3M
TEMP.	-29° to 425°c



PRODUCT INT-P01PBV- PNEUNATIC OPERATED BALL VALVE 2 PIECE

SIZE	½" to 4"
SEAT	PTFE/CFT/GFT/ TFM/PEEK
PRESSURE	10 bar to 64 bar
ENDS.	SCREWED END/
MOC	WCB / CF8 / CF8M / CF3M
TEMP.	-29° to 200°c



PRODUCT INT-P02PSB- PNEUNATIC OPERATED BALL VALVE 3 PIECE

SIZE	1 ½" to 10"
SEAT	PTFE/CFT/GFT/ TFM/PEEK
PRESSURE	150# to 300#
ENDS.	FLANGED END/
MOC	WCB / CF8 / CF8M / CF3M
TEMP.	-29° to 425°c



PRODUCT INT-P03PBV- PNEUNATIC OPERATED BALL VALVE 3 PIECE

SIZE	2" to 24"
SEAT	PTFE/EPD/VITON/SI LICON/NITRILE
PRESSURE	PN10/PN16/PN 40
ENDS.	FLANDEG END/
MOC	C.I/WCB/CF8/ CF8M
TEMP.	-29° to 230°c



PRODUCT INT-P04PWB- PNEUNATIC OPERATED BUTTERFLY VALVE

SIZE	2" to 24"
SEAT	PTFE/EPD/VITON/SI LICON/NITRILE
PRESSURE	150# to 300#
ENDS.	FLANGED END/
MOC	C.I/WCB/CF8/ CF8M
TEMP.	-29° to 230°c



PRODUCT INT-P05PWB- PNEUNATIC OPERATED DOUBLE FLANGE BUTTERFLY VALVE

SIZE	2" to 24"
SEAT	PTFE/EPD/VITON/SI LICON/NITRILE
PRESSURE	150# to 300#
ENDS.	FLANGED END/
MOC	C.I/WCB/CF8/ CF8M
TEMP.	-29° to 230°c



PRODUCT INT-P06PWB - PNEUNATIC OPERATED LUG TYPE BUTTERFLY VALVE

SIZE	2" to 12"
SEAT	S.S 410 / CF8 / CF8M
PRESSURE	150# to 300#
ENDS.	FLANGED END/
MOC	WCB / CF8 / CF8M / CF3M
TEMP.	-29° to 425°c



PRODUCT INT-P07PGV- PNEUNATIC OPERATED GATE VALVE

SIZE	DN25 TO DN100
TRIMS	AS PER MATERIAL
PRESSURE	10 bar to 64 bar
ENDS.	FLANGED END/
MOC	WCB / CF8 / CF8M / CF3M
TEMP.	-29° to 200°c





PRODUCT INT-P08PGC- PNEUNATIC OPERATED GLOBE CONTROL VALVE

Electric Operated Valves

SIZE	1" to 12"	
SEAT	PTFE/CFT/GFT/TFM/PEEK	
PRESSURE	150# to 300#	
ENDS.	FLANGED END/	
MOC	WCB / CF8 / CF8M / CF3M	
TEMP.	-29° to 425°c	
PRODUCT	INT-E01EBV- ELECTRIC OPERATED BALL VALVE 2 PIECE	

SIZE	½" to 4"	
SEAT	PTFE/CFT/GFT/TFM/PEEK	
PRESSURE	10 bar to 64 bar	
ENDS.	SCREWED END/	
MOC	WCB / CF8 / CF8M / CF3M	
TEMP.	-29° to 200°c	
PRODUCT	INT-E02ESB- ELECTRIC OPERATED BALL VALVE 3 PIECE	

SIZE	1 ½" to 10"	
SEAT	PTFE/CFT/GFT/TFM/PEEK	
PRESSURE	150# to 300#	
ENDS.	FLANGED END/	
MOC	WCB / CF8 / CF8M / CF3M	
TEMP.	-29° to 425°c	
PRODUCT	INT-E03EBV- ELECTRIC OPERATED BALL VALVE 3 PIECE	

SIZE	2" to 24"	
SEAT	PTFE/EPD/VITON/SILICON/NITRILE	
PRESSURE	PN10/PN16/PN 40	
ENDS.	FLANDEG END/	
MOC	C.I/WCB/CF8/CF8M	
TEMP.	-29° to 230°c	
PRODUCT	INT-E04EWB- ELECTRIC OPERATED BUTTERFLY VALVE	

SIZE	2" to 24"	
SEAT	PTFE/EPD/VITON/SILICON/NITRILE	
PRESSURE	150# to 300#	
ENDS.	FLANGED END/	
MOC	C.I/WCB/CF8/CF8M	
TEMP.	-29° to 230°c	
PRODUCT	INT-E05EWB- ELECTRIC OPERATED DOUBLE FLANGE BUTTERFLY VALVE	

SIZE	2" to 24"	
SEAT	PTFE/EPD/VITON/SILICON/NITRILE	
PRESSURE	150# to 300#	
ENDS.	FLANGED END/	
MOC	C.I/WCB/CF8/CF8M	
TEMP.	-29° to 230°c	
PRODUCT	INT-E06EWB - ELECTRIC OPERATED LUG TYPE BUTTERFLY VALVE	

SIZE	2" to 12"	
SEAT	S.S 410 / CF8 / CF8M	
PRESSURE	150# to 300#	
ENDS.	FLANGED END/	
MOC	WCB / CF8 / CF8M / CF3M	
TEMP.	-29° to 425°c	
PRODUCT	INT-E07EGV- ELECTRIC OPERATED GATE VALVE	

SIZE	DN25 TO DN100	
SEAT	S.S 410 / CF8 / CF8M	
PRESSURE	150# to 300#	
ENDS.	FLANGED END/	
MOC	WCB / CF8 / CF8M / CF3M	
TEMP.	-29° to 425°c	
PRODUCT	INT-E08EGV- ELECTRIC OPERATED GLOBE VALVE	

Our Extended Product Line

SIZE	2" to 16"	
MFG. STD	API 594	
PRESSURE	150# to 300#	
ENDS.	Wafer Type/	
MOC	C.I/ WCB / CF8 / CF8M / CF3M	
TESTING.	API 598	
PRODUCT	DUAL PLATE CHECK VALVE	

SIZE	2" to 16"	
MFG. STD	API 594	
PRESSURE	150# to 300#	
ENDS.	Flanged End,RF	
MOC	C.I/ WCB / CF8 / CF8M / CF3M	
TESTING.	API 598	
PRODUCT	DOUBLE FLANGED DUAL PLATE CHECK VALVE	

SIZE	1" to 24"	
MFG. STD	API 594	
PRESSURE	150#	
ENDS.	Wafer Type/	
MOC	C.I/ WCB / CF8 / CF8M / CF3M	
TESTING.	API 598	
PRODUCT	WAFER TYPE CHECK VALVE	

SIZE	15MM TO 100 MM	
DESIGN. STD	BS 7438	
PRESSURE	150#	
ENDS.	Wafer Type/	
MOC	CF8 / CF8M / CF3M	
TESTING.	API 598	
PRODUCT	I.C DISC CHECK VALVE	

SIZE	2" to 24"	
DESIGN. STD.	MFG.	
PRESSURE	150#	
ENDS.	FLANGE END RF/	
MOC	WCB/CF8/CF8M	
TESTING.	API 598	
PRODUCT	"BASKET" TYPE STRAINER	

SIZE	2" to 10"	
DESIGN. STD.	MFG.	
PRESSURE	150#	
ENDS.	FLANGE END RF/	
MOC	WCB/CF8/CF8M	
TESTING.	API 598	
PRODUCT	"POT" TYPE STRAINER	

SIZE	2" to 24"	
DESIGN. STD.	MFG.	
PRESSURE	150#	
ENDS.	FLANGE END RF/	
MOC	WCB/CF8/CF8M	
TESTING.	API 598	
PRODUCT	DOUBLE WINDOW SIGHT GLASS	

SIZE	2" to 24"	
DESIGN. STD.	MFG.	
PRESSURE	150#	
ENDS.	FLANGE END RF/	
MOC	WCB/CF8/CF8M	
TESTING.	API 598	
PRODUCT	I.C FULL VIEW SIGHT GLASS	



INTROTM

VALVE INDUSTRIES

The Quality Creators

MANUFACTURER - EXPORTER OF INDUSTRIAL VALVES



OFFICE ADDRESS :	05,UJAMA NAGAR V-I,MAHAMMADI MASJID,ILABEN FARM NEAR AL-HABIB, DANI LIMDA, AHMEDABAD, GUJARAT-380028	CONTACT NO.
FACTORY ADDRESS 1 :	20 RAJNAGAR ESTATE NEAR VISHWANATH NAGAR, AJIT MILL , RAKHIAL AHMEDABAD GUJARAT-380023	+91 7046104970
FACTORY ADDRESS 2 :	37, ABAD ESTATE, OPPOSITE KASHIRAM MILL, RAJESHWARI SOCIETY, NAROLGAM, AHMEDABAD, GUJARAT-382405	+91 8128254584
E-MAIL :	Introvalve.industrial@outlook.com info@introvalves.com , sales@introvalves.com	+91 7226838634
WEB:	https://www.introvalves.com	



For Guaranteed
Trouble-Free Service 